

RECHARGEABLE SEALED LEAD ACID BATTERY

SPECIFICATION

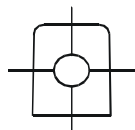

mm(inch)

(M8 Bolt)
F5

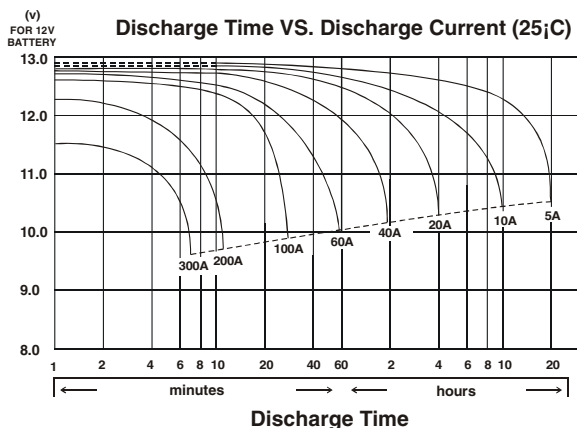
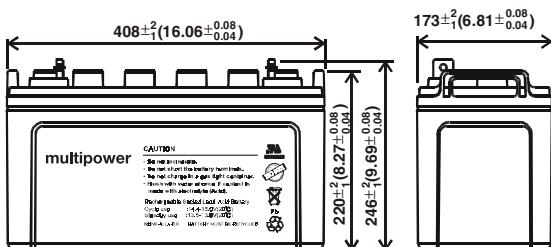
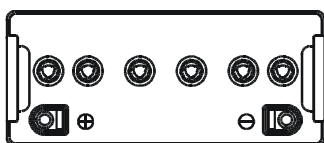

MP100-12

Nominal Voltage (V) 12V

Nominal Capacity
 20hour rate (5A to 10.50V) 100Ah
 10hour rate (10A to 10.50V) 100Ah
 5hour rate (17A to 10.20V) 85Ah
 1C (100A to 9.60V) 45Ah
 3C (300A to 9.60V) 35Ah

Weight 37.51kg(82.71Lbs.)

Internal Resistance (at 1KHz) 4 mΩ

Maximum Discharge Current for 30 seconds : 1000A

Maximum Discharge Current for 5 seconds : 2000A

Operating Temperature Range

Charge 0°C (32°F) to 40°C (104°F)
 Discharge -15°C (5°F) to 50°C (122°F)
 Storage -15°C (5°F) to 40°C (104°F)

Charge Retention (shelf life) at 20°C (68°F)

1 month 92%
 3 month 90%
 6 month 80%

Charging Methods at 25°C (77°F)

Cycle use:
 Charging Voltage 14.4 to 15.0V
 Maximum Charging Current: 30A
Standby use:
 Float Charging Voltage 13.50 to 13.80V

Life expectancy :

Cycle Use:
 100% depth of discharge 200 cycles
 80% depth of discharge 225 cycles
 50% depth of discharge 500 cycles

Standby Use: 3-5 years

Case Material ABS
 (Option: 94-HB & 94V-0 flame retardant case)

Terminal F5